

## BELLOWS SEALED STOP VALVES VF20

### DESCRIPTION

The VF20 series are streamlined flow valves with bellows, outside screw, no rising stem and maintenance free. They are specially recommended for use with steam, gases, liquids, condensate, thermal oil and water systems.

### MAIN FEATURES

Double wall bellows, specially designed for high durability.  
 Position indicator.  
 Lubricator.  
 Maintenance free.  
 Secondary safety sealing.

OPTIONS: Parabolic plug.  
 PTFE disc sealing (max. 180 °C).

USE: Group 2 fluids compatible with the construction (see "Body limiting conditions" table).

### AVAILABLE

MODELS: VF20 – Cast iron.

SIZES: DN 15 to DN 200.

CONNECTIONS: Flanged EN 1092-2 PN16.

INSTALLATION: See IMI – Installation and maintenance instructions.



CE MARKING – GROUP 2 (PED – European Directive)	
PN16	Category
DN 15 to DN 50	SEP
DN 65 to DN 200	1 (CE marked)

BODY LIMITING CONDITIONS *	
ALLOWABLE PRESSURE	RELATED TEMPERATURE
16 bar	- 10 °C / 120 °C
12,8 bar	200 °C
11,2 bar	250 °C
9,6 bar	300 °C

\* Warning: The eventual use with steam/gas should be analyzed in accordance with the local applicable legislation, and always ensuring that there is no risk of water hammer.

**DIMENSIONS (mm)**

SIZE DN	A	B	C	D	WGT. (kg)	Kvs (m <sup>3</sup> /h)
15	130	47,5	178	125	3,2	5,9
20	150	52,5	178	125	3,9	7,4
25	160	57,5	193	125	4,6	13
32	180	70	201	125	6,5	18
40	200	75	224	150	9	30
50	230	82,5	228	150	11	41
65	290	92,5	270	175	15,8	79
80	310	100	295	200	20,5	115
100	350	110	352	250	35	181
125	400	125	380	300	49	225
150	480	142,5	427	400	76	364
200	600	170	569	500	130,5	725

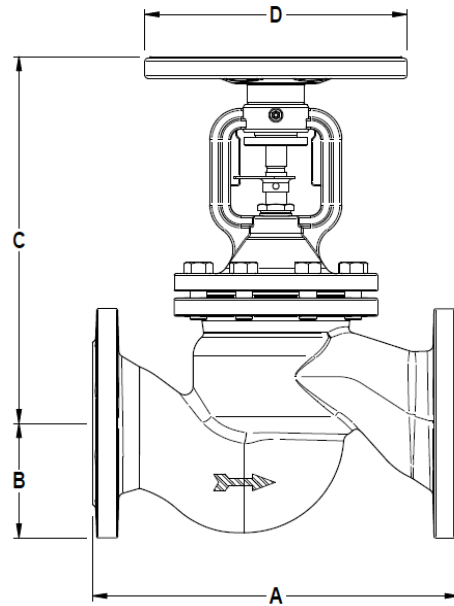

**MATERIALS**

POS. N°	DESIGNATION	MATERIAL
1	Body	EN-GJL-250
2	Seat	Stainless steel
3	* Spindle	Stainless steel
4	* Disc	Stainless steel
5	Bonnet	EN-GJS-400-18-LT
6	* Bellows	Stainless steel
7	* Gasket	Stainless steel / Graphite
8	* Packing	Carbo-graphite
9	Gland	Zinc plated steel
10	Anti-friction disc	Zinc plated steel
11	Handwheel	Steel
12	Bolts	Steel 8.8

\* Available spare parts.

